

**ARBORETUM, DUNKIRK AND LENTON, RADFORD AND PARK AREA COMMITTEE**  
**27 FEBRUARY 2013**

<b>Title of paper:</b>	<b>Major Parks Projects in Area 4:</b>	
	<ul style="list-style-type: none"> <li>• Forest Recreation Ground Sports Zone</li> <li>• Arboretum Café</li> </ul>	
<b>Director(s)/ Corporate Director(s):</b>	John Kelly Corporate Director for Communities	<b>Wards affected:</b> Arboretum
<b>Report author(s) and contact details:</b>	Eddie Curry, Head of Parks & Open Spaces 015 876 4982 James Dymond, Parks Development Manager 0115 876 4983	
<b>Other colleagues who have provided input:</b>	None	
<b>Relevant Council Plan Strategic Priority: (you must mark X in the relevant boxes below)</b>		
World Class Nottingham		
Work in Nottingham		
Safer Nottingham		<b>X</b>
Neighbourhood Nottingham		<b>X</b>
Family Nottingham		<b>X</b>
Healthy Nottingham		<b>X</b>
Leading Nottingham		
<b>Summary of issues (including benefits to citizens/service users):</b>		
The report summarises proposals for future improvements to the Sports Zone at the Forest Recreation Ground and the development of a new pavilion / café at the Arboretum.		
<b>Recommendation(s):</b>		
1	That the Committee notes the contents of the report and the improvements proposed to the Forest Recreation Ground sports zone.	
2	That the Committee approves the allocation of Section 106 funding to the two projects as outlined in section 4.	
3	That the Committee considers the allocation of Area Capital funding to the projects.	

**1. BACKGROUND**

**Forest Sports Zone**

The £5.2m heritage restoration of Nottingham's inner-city 77 acre Forest Recreation Ground is well underway and will transform the site to a key green space for the area and the City, as well as to its former Victorian glory.

The current Forest Multi-Activity Pitch (FMAP), however, is not addressed in the heritage project and requires refurbishment and a new management approach to better fit with current and future demand.

The current FMAP facilities:



Key drivers for the project are:

- significant demand from local residents;
- current poor quality sports provision;
- lack of dedicated facility management;
- important health issues /concerns affecting the local population;
- accessibility to good quality sporting facilities and the way current agencies employ these restricts community usage for potential / current users.

## Vision

***To create a top class sports provision on the Forest site with state of the art sporting facilities which are inclusive and accessible to all members of the community, particularly aimed to engage disadvantaged groups.***

***To use sport as a vehicle for engaging young people who would otherwise drift into crime, anti-social behaviour and gang related activity.***

**Sports Zone Proposals (see site map at Appendix 1) include:**

- construction of a new full size 3G pitch;
- upgrade of the existing FMAP;
- upgrade of existing grass pitches;
- cricket training nets and artificial wickets;
- new multi-use games area;
- new pavilion to service sports teams and accommodate community engagement programmes (planning permission secured in October 2012).
- a management and maintenance plan to ensure the facilities are well managed and kept in good use;
- an ambitious outreach programme to target young people who do not normally access facilities and who would otherwise drift into crime;
- creating a range of new apprenticeships and accreditations;
- supplementary mentoring and lifestyle coaching.

## Wider Benefits

Nottingham partners have a strong track record of using sport to engage excluded and disadvantaged groups, particularly teenagers and young adults who are already, or are at risk of, becoming involved in crime and antisocial behaviour. Starting with sport as common ground, workers are able to build trust with young people, taking them on to achieve qualifications, build their confidence and aspirations, and develop their social and

relationship skills. Using sport in this diverse area is also expected to help break down barriers between different ethnic and cultural groups and enable groups from different areas of the City to work and learn alongside each other.

The Pavilion will enable youth and sports groups to offer targeted support, relationship and sexual health advice, education opportunities and routes to employment to young people usually considered 'hard to reach'. This is much more than just a sport facility, it is an opportunity to build bridges, develop aspirations and reduce tensions in a deprived area.

## Partnership Approach

Partner aims:

- to operate and maintain a vibrant, high quality mixed use sports facility including but not limited to football, hockey and cricket - with new changing/clubhouse facilities;
- to engage and maintain community participation based not on short term grants but on a sustainable/realistic business model;
- to engage disadvantaged young people who would otherwise drift into gangs, crime and antisocial behaviour, using sports as a vehicle to:
  - deter the use of drugs, getting into crime and joining in gang culture/activity;
  - offer a variety of educational and lifestyle training opportunities such as:
    - education in lifestyle coaching e.g. sexual health;
    - re-engagement with the education system;
    - apprenticeships opportunities.

## Future Management

Nottingham Forest Football in the Community are at the preferred status stage for the management and operation of the site once the proposed improvements have been undertaken.

The interested party is a trust with charitable status who have opportunities for attracting funding towards developing the site.

Concession terms are to be agreed and will be for a minimum of 20 years (final length of contract dependent on funding bid terms).

## Arboretum Café

The former public house building at the Arboretum was demolished following a fire in December 2006 leaving only two buttressed brick wing walls standing, together with the boundary walls, steel fences, gates and a coach house. The site is now secured with a timber fence between the two wing walls to the south, palisade fencing to the east and west and the stone boundary walls, steel fence and coach house to the north.



## Proposals

Proposals for a new café and community building on the site are progressing with initial design concepts received and consultation undertaken at on-site events during 2012. The

building will include a café, toilets, education room and restoration of the existing historic “stable-block” building.

Outline costs for a building were received in January 2013 and total approximately £381,000, including contingencies and fees. However, these estimates do not include external landscaping.

The current funding proposals are as follows – including a proposal to allocate further Section 106 funding to the project to enable the external landscaping works to take place at the same time as the build:

<b>Secured</b>	
Section 106	£311,000
<b>Proposed</b>	
WREN bid April 2013	£50,000
Veolia bid April 2013	£50,000
Additional Section 106	£34,000
<b>Total</b>	<b>£445,000</b>

It is proposed to bring a further report to the Committee once designs have been developed further for the new building.

**2. REASONS FOR RECOMMENDATIONS (INCLUDING OUTCOMES OF CONSULTATION)**

Additional funding is required for both schemes to proceed.

**3. OTHER OPTIONS CONSIDERED IN MAKING RECOMMENDATIONS**

None.

**4. FINANCIAL IMPLICATIONS (INCLUDING VALUE FOR MONEY/VAT)**

**Forest Sports Zone:**

<b>Capital Cost Plan</b>	
<b>Item</b>	<b>Costs</b>
Demolition and Site Clearance	£ 24,785
Footpaths Construction	£ 38,257
Sports Equipment	£ 600,000
Landscaping	£ 5,385
Contingency on above	£ 66,842
New Building, Changing Room / Club House	£950,000
Contingency on above	£90,000
Project Management Fees (1 year)	£25,000
<b>OVERALL ESTIMATED PROJECT COSTS</b>	<b>£1,800,269</b>

<b>Potential Funding Mix</b>	
<b>Funding Body</b>	<b>Amount</b>
Football Foundation: Grass Roots Facilities Fund	£500,000
Football Foundation: Premier League Community Facility Fund	£350,000
Sport England: Inspired Facilities Fund	£100,000
Parks Match Funding	£150,000
NCC Parks (prudential borrowing)	£150,000
Section 106	£115,000
Area Capital	£20,000
<b>Sub total</b>	<b>£1,385,000</b>
<i>Proposals to meet shortfall:</i>	
<i>NHS funding</i>	<i>£200,000</i>
<i>Crime / anti-social behaviour funding</i>	<i>£200,000</i>

### **Section 106:**

The following Section 106 funding is currently available and unallocated in Area 4:

<b>S106 Funding</b>	<b>Proposals</b>
£80,000 - Arboretum ward.	Forest Sports Zone - £80,000
£69,000 – from a development at 116-120 Talbot St (which falls into both the Arboretum Ward and the City Centre).	Forest Sports Zone - £40,000 Arboretum café - £29,000
<b>TOTAL</b>	<b>£149,000</b>

### **5. RISK MANAGEMENT ISSUES (INCLUDING LEGAL IMPLICATIONS AND CRIME AND DISORDER ACT IMPLICATIONS)**

None.

### **6. EQUALITY IMPACT ASSESSMENT**

The Equality Impact Assessment for Forest is attached as Appendix 2



### **7. LIST OF BACKGROUND PAPERS OTHER THAN PUBLISHED WORKS OR THOSE DISCLOSING CONFIDENTIAL OR EXEMPT INFORMATION**

None.

### **8. PUBLISHED DOCUMENTS REFERRED TO IN COMPILING THIS REPORT**

None.

Appendix 1: Sports Zone Proposals

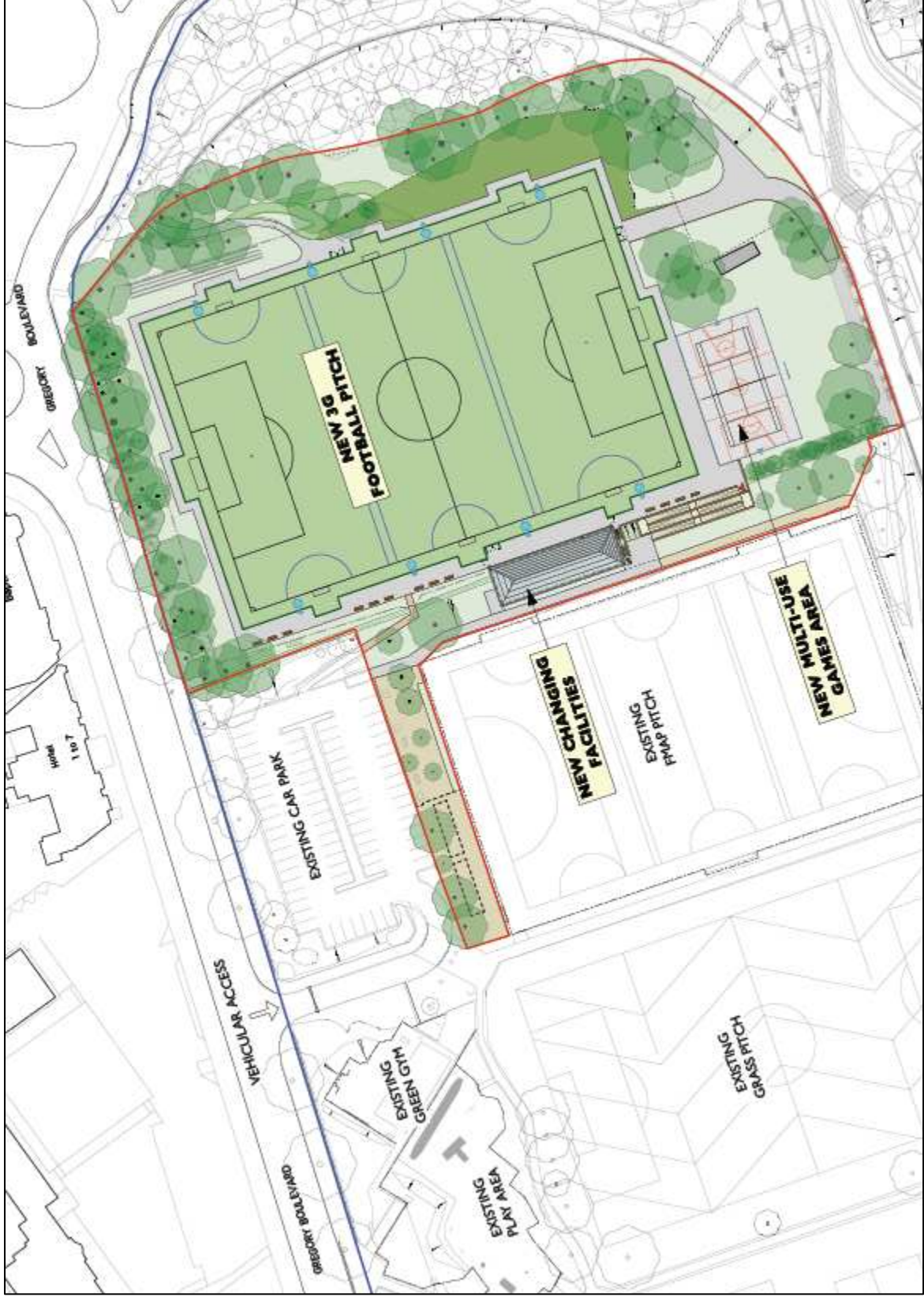

## Appendix 2: Equality Impact Assessment

<b>Name and brief description of proposal / policy / service being assessed</b>				
<p>Forest Sports Zone – Concession for the future operation and management of the site.</p> <p>The future operation &amp; management of The Forest Sports Zone is being offered up as a saving and as such is being outsourced as a concession through the Nottingham City Council procurement process. As such all tenders received will be subject to the statutory procedures in place for such a process including the transference of staff. The Council's aim is to no longer subsidise the operation going forwards. The subject of this EIA is to assess the proposed transfer of Forest Sports Zone to a third party organisation ensuring that there is continued community access.</p> <p>Nottingham City Council considers that for a third party organisation to take on the operation provides the best opportunity. A third party offers the possibility of being able to attract capital investment to help further develop the site, which in the first instance will extend current provision and in the longer term offer a better quality facility to undertake community programmes and projects which will have beneficial impacts on local residents.</p> <p>The Council believes there will be interest in operating this facility and therefore is undertaking a proper procurement process.</p>				
<b>Information used to analyse the effects on equality</b>				
<p>The service has looked at how it currently provide opportunities for community engagement on the site and has a number of service level agreements with sports clubs and schools to use the site which impact on local residents. In transferring the operation &amp; management of the site there will be future agreements that ensure there are future agreements to ensure local clubs, schools &amp; groups continue to use the site.</p> <p>Consultation has taken place with local interested groups, stakeholders, schools and local residents to determine their interest in improving the site. 95% of respondents thought the Sports Zone needed to be improved and there were 177 suggestions for improvements.</p> <p>The preferred operator will be delivering agreed projects and programme including coached activities, training schemes and community based provision at the site directed at local residents especially those who are at risk of crime &amp; anti-social behaviour, low educational achievement or have high risk of ill-health.</p>				
	<b>Could particularly benefit (X)</b>	<b>May adversely impact (X)</b>	How different groups could be affected: Summary of impacts	Details of actions to reduce negative or increase positive impact (or why action not possible)
People from different ethnic groups	<input type="checkbox"/>	<input type="checkbox"/>	No Adverse Effect	The current proposal to operate and manage the site will not in the short term make any significant changes which will impact on specific groups. If following
Men, women (including maternity/pregnancy impact), transgender people	<input type="checkbox"/>	<input type="checkbox"/>	No Adverse Effect	

Disabled people or carers	<input type="checkbox"/>	<input type="checkbox"/>	No Adverse Effect	the transfer of the site it can continue its plans to develop the site, then there will be significant outcomes which will particularly benefit older or younger people and Other (e.g. marriage/civil partnership, looked after children, cohesion/good relations, vulnerable children/adults).
People from different faith groups	<input type="checkbox"/>	<input type="checkbox"/>	No Adverse Effect	
Lesbian, gay or bisexual people	<input type="checkbox"/>	<input type="checkbox"/>	No Adverse Effect	
Older or younger people	<input checked="" type="checkbox"/>	<input type="checkbox"/>	No Adverse Effect	
Other (e.g. marriage/civil partnership, looked after children, cohesion/good relations, vulnerable children/adults)	<input type="checkbox"/>	<input type="checkbox"/>	No Adverse Effect	

**Outcome(s) of equality impact assessment:**

No major change needed  Adjust the policy  Adverse impact but continue   
 Stop and remove the policy/proposal

**Arrangements for future monitoring of equality impact of this proposal / policy / service:**

Equality Impacts will be assessed when the redesigned facilities and funding have been confirmed. It is likely that that these will have a significant impact on the future service delivered and will be judged by numbers attending, age and ethnicity both of staff and users.

Approved by (manager signature): Eddie Curry

Date sent to equality team for publishing: November 2012